

## Technical Data Sheet – MagFly® Universal Magnet

### Product Description

The MagFly® universal magnet is equipped with the patented Mag-Fly® functionality and is versatile. Two threaded holes M16 x 1.5 are available as standard for mounting adapters and accessories. Furthermore, different adhesive forces, sizes and designs ensure that the right holding magnet is available for different applications.

### Product Features

- ::: Easy handling and exact positioning thanks to integrated MagFly® technology
- ::: No additional tool required for loosening, the fixed eccentric lever is not only practical, it saves time
- ::: Multifunctional use thanks to a wide range of accessories and adapters
- ::: Scalable for a wide range of applications, as different sizes and holding forces are available depending on requirements
- ::: High-quality materials and the torsion-resistant design ensure an extremely long service life
- ::: Integrated lifter

### Areas of Application

- ::: Multifunctional application possibilities thanks to a wide range of accessories and adapters
- ::: Suitable for tilting tables and steel pallets
- ::: Compatible with Multiform and FlyFrame® formwork systems®

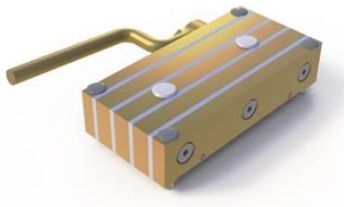

### Technical Data

Article number	8001052	8001055	8001060	8001064	8001065
Name	MagFly® 1000 k	MagFly® 1600 k	MagFly® 2000 k	MagFly® 2500 k	MagFly® 3000 k
Adhesive force (N)	11.000	16.000	22.000	27.000	33.000
Mass (kg)	5	7,5	10	12,5	15
L1 (mm)	230	230	230	230	230
L2 (mm)	270	270	270	270	270
W1 (mm)	60	85	110	135	160
W2 (mm)	115	140	165	190	215
H1 (mm)	50	50	50	50	50
H2 (mm)	65	65	65	65	65

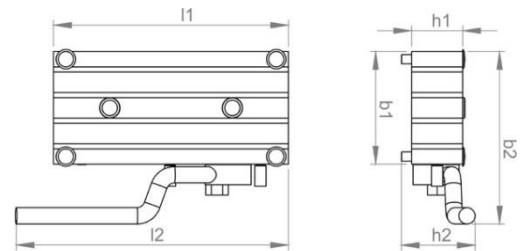

The information in this data sheet was provided with care based on our experience and the respective known state of science and technology but is non-binding. They are to be adapted to the respective building object, intended use and the special local stresses. Provided that this is the case, we ask you to understand that we limit our liability for the information given in this data sheet and accept no liability in the event of intent, gross negligence or infringement of the instructions. In any case, the recognised rules of technology must be observed.

Edition 05/19 - This data sheet has been technically revised. Previous editions are invalid. If a new edition has been technically revised, this edition loses its validity. Please check whether you are in possession of the current edition.